

Super Lite

Floor Plans

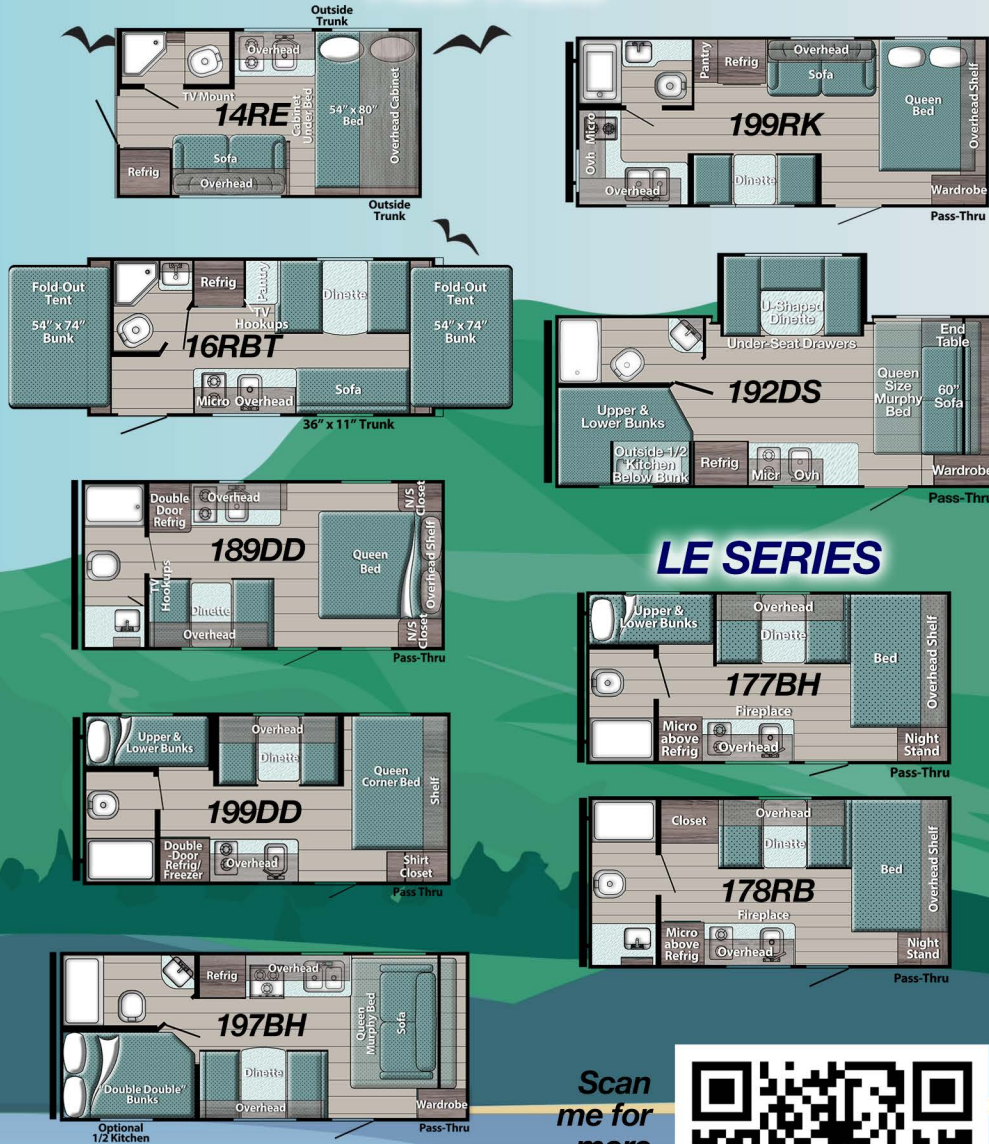

LE SERIES

As our most affordable series, Super Lite Travel Trailers have features and floor plans perfect for tight budgets, first-timers, and casual campers.

Standard Features & Packages

Standard Features

- High-Performance Vinyl Flooring
- Fabric-Wrapped Box Valances
- Craft-made Cabinetry w/Designer Pulls
- Easy-Care Wall Vinyl
- Laminated Countertops w/Vinyl T-Molding
- White Kitchen Sink
- 30 Amp Svc w/45 Amp Converter/Charger
- Wall-Mount Fire Extinguisher
- Combo CO/LP Detector
- Smoke Detector
- Monitor Panel
- Pleated Shades
- Seamless Synthetic Vinyl Roof
- Diamond Plate Lower Front
- Radius Safety Glass Windows
- Safety Chains
- Single Entry Step

Camping Package (Included, required)

- 2-Burner Gas Cooktop
- Microwave Oven
- Tankless Water Heater
- 13,500 BTU Roof Air Conditioner
- 20 lb. LP Gas Tank
- Shower & Toilet
- (2) Rear Stabilizer Jacks
- Power Awning
- Teddy Bear Mattress(es) (Bunk models)
- Wood Ceiling Trim
- 6'8" Interior Height
- High-Rise Kitchen Faucet
- 26" Friction Hinge Entry Door
- Central Control Panel
- Radial Tires
- LED Interior Lights
- 20,000 BTU Furnace (N/A 177BH, 178RB)
- Multiple USB Ports
- Foot Pad on Front Jack

Convenience Package (required)

- 10 cu. ft. 12V Refrigerator (197BH, 192DS, 19RD, 199RK)
- TV Antenna
- Swing-Away Grab Handle
- Pot & Pan Drawer (189DD, 199DD)

Rocky Mountain Edition (189DD, 199DD, 197BH only)

- Overslung Axle
- Knobby Tires
- Fender Covers
- Wheel Wells
- Double Entry Step
- Upgraded Wheels
- Bottom Diamond Plate Metal

www.gulfstreamcoach.com
503 S Oakland Ave. • Nappanee, IN 46550

Popular Options

- Blue Tooth Radio w/2 Interior & 2 Exterior Speakers, plus Prep for Solar Panel & Prep for Backup Camera
- Bedspread
- Spare Tire
- Fiberglass Walls
- Double SolidStep™ Entry Step (Std. 14RE)
- 1/2 Outside Kitchen (197BH, 192DS only)
- Front Power Hitch Jack

Specifications

Specifications are approximate and subject to change. For actual weights, check weight sticker in each unit.

LE SERIES

| | 14RE | 16RBT | 189DD | 199DD | 197BH | 199RK | 192DS | 177BH | 178RB |
|-----------------------|----------|----------|----------|----------|----------|----------|----------|------------|------------|
| Length | 16'1" | 19'1" | 20'11" | 20'11" | 22'2" | 22'2" | 22'3" | 20'11" | 20'11" |
| Width | 90" | 84" | 96" | 96" | 96" | 96" | 96" | 96" | 96" |
| Height w/AC | 10'3" | 10'8" | 10'4" | 10'4" | 10'3" | 10'3" | 10'5" | 10'4" | 10'4" |
| Int. Height | 6'8" | 6'8" | 6'8" | 6'8" | 6'8" | 6'8" | 6'8" | 6'8" | 6'8" |
| Base Weight | 2,870 | 3,170 | 2,996 | 3,100 | 3,690 | 3,500 | 3,940 | 2,810 | 2,920 |
| Hitch Weight | 300 | 340 | 350 | 360 | 638 | 470 | 400 | 330 | 360 |
| Net Carry Cap. | 930 | 670 | 854 | 760 | 1,348 | 1,370 | 860 | 1,020 | 1,080 |
| Fresh Water | 23 | 23 | 23 | 23 | 23 | 23 | 23 | 23 | 23 |
| Grey Tank | 34 | 27 | 34 | 34 | 34 | 34 | 34 | 34 | 34 |
| Black Tank | 33 | 27 | 34 | 34 | 34 | 34 | 34 | 34 | 34 |
| Furnace BTUs | 20,000 | 20,000 | 20,000 | 20,000 | 20,000 | 20,000 | 20,000 | (Elec. FP) | (Elec. FP) |
| Water Heater | Tankless | Tankless | Tankless | Tankless | Tankless | Tankless | Tankless | Tankless | Tankless |
| LP Tank lbs. | 20 | 20 | 20 | 20 | 20 | 20 | 20 | 20 | 20 |

Specifications, materials, and features are subject to change without further notice. Not responsible for typographical errors. Visit www.gulfstreamcoach.com or your dealer for more information. ©2024 Gulf Stream Coach, Nappanee, IN 46550 USA • #AMESUP122024

Scan me for more info



QUALITY • VALUE • INNOVATION